



LITHIUM-ION RECHARGEABLE BATTERY

PRODUCT DATA SHEET

MODEL ICP-103450-M20A

■ CELL SPECIFICATIONS

Capacity	Typical	2000 mAh 7.4Wh
	Minimum	1900 mAh 7.0Wh
Cell Voltage	Nominal	3.7V
	Charge	4.2V
	Discharge	3.0V
Charge Current	Standard	2A
	Maximum	6A
Charge Time	Standard	1.5 hr
Discharge Current	Maximum	4A
Internal Resistance	AC (1 KHz)	<45 mΩ
Ambient Temperature	Charge	0°C to 60°C
	Discharge	-30°C to 60°C
Energy Density	Gravimetric	187Wh/kg
	Volumetric	414Wh/l

■ PHYSICAL CHARACTERISTICS

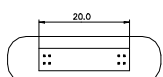
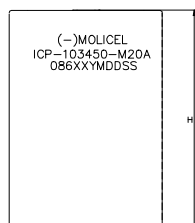
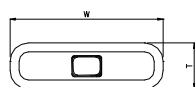

Shape	Prismatic
Can	Aluminum
Dimension	
Thickness (T)	*10.8 mm (Max) **12.0 mm (Max)
Width (W)	34 mm (Max)
Height (H)	50 mm (Max)
Tab Dimensions (Positive)	5 x 20 mm
Weight	42.0g (Max)
*Thickness at shipping state	
**Thickness after 1C 1000 cycles at 23°C	

This cell include thermal breaker inside.
The information contained herein is for reference only and does not imply a performance guarantee or a product warranty. Specifications and characteristics are subject to change without prior notice.
For application specific information, please contact E-One Moli Energy Sales and Applications or the nearest MOLICEL® recognized agent.

■ Charge Characteristics

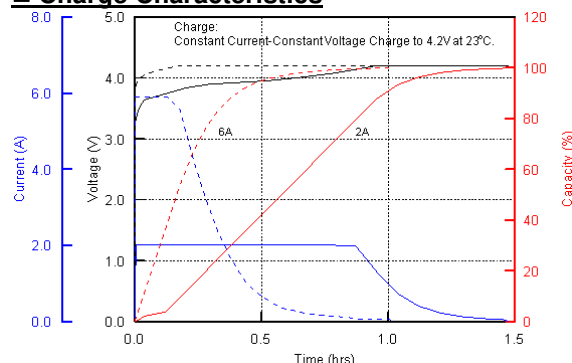

■ Discharge Rate Characteristics

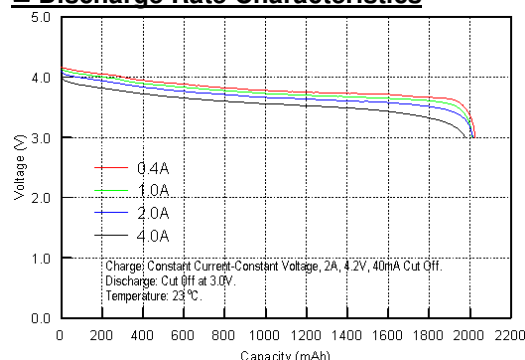

■ Discharge Temperature Characteristic

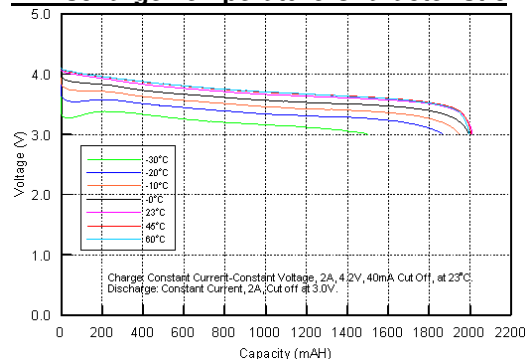

■ Cycle Characteristics

