

## BENEFITS:

- More cost-benefits for everyday use
- Good performance on moderate to low-drain devices



## APPLICATIONS BEST FOR:



- GP Supercell Carbon Zinc Battery
- AAA size
- 1.5 Volts

## Other Details:

- Carbon Zinc chemistry
- Cylindrical cell type
- Average weight: 8.5g

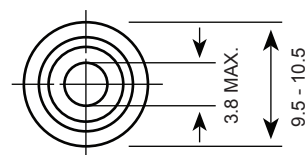

## Typical Service Life:

Discharge Resistance	Discharge Condition	End Point Voltage	Service Life
10 ohms	1 Hr/Day	0.9V	2.7 Hrs

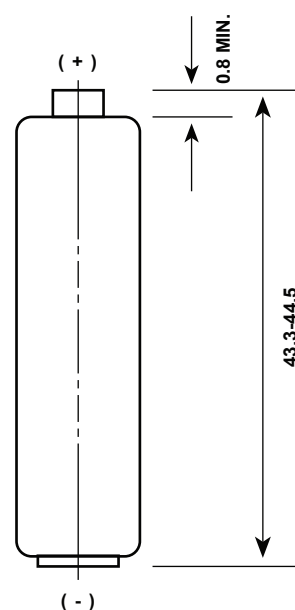
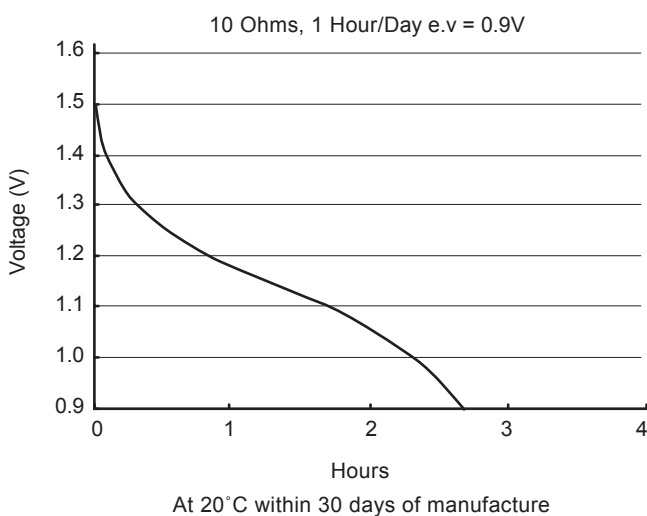

Unit : mm

Model No.: **GP24S**