

Data Sheet

Recommended Application: Photo

6204

Type Designation	CR P2
Designation IEC	CR P2
System	Li-MnO ₂
Shelf Life *	10 years
Nominal Voltage [V]	6
Typical Capacity C [mAh]	1600 (Load 390 Ω at 20 °C down to 3.6V)
Permissible Temperature Range	- 20 °C ... 70 °C
Weight, approx. [g]	38
Volume [ccm]	20.4

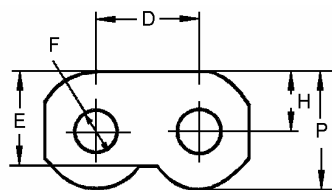

Dimensions [mm]

min: max:

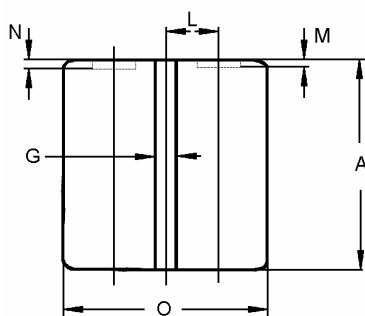

A	34.5	36.0
O	32.5	35.0
P	18.5	19.5
D	16.8	16.8
E	15.3	16.2
H	9.2	9.8
F	7.5	8.7
L	8.4	8.4
M	0.1	1.0
N	0.7	1.5
G	1.3	-

Typical Capacities (at 20 °C)

Discharge Type	Load	End Voltage[V]	4.0	3.6
Pulse Test 15s/m, 7d/w	7.5 Ω	Time [cy]	475	495
		Capacity [Ah]	1.36	1.39
		Energy [Wh]	6.9	7.1
Discharge Type	Load	End Voltage[V]	4.0	3.6
Service Output Test 24h/d, 7d/w	390 Ω	Time [h]	108	112
		Capacity [Ah]	1.57	1.61
		Energy [Wh]	8.65	8.85

* In consideration of typical loss of capacity at storage and application